

# Series GMK

## Motor type 404 880

Design Data	
Commutation	Brushed
Direction of rotation	Bi-directional
Bearing type	A:Ball - B:Sleeve

Performance data		
Rated voltage [V]	$U_N$	24
Nominal torque [Nm]	$M_N$	0.15
No-load speed [ $\text{min}^{-1}$ ]	$n_0$	2,200.0
Nominal power [W]	$P_N$	30.9
Nominal current [A]	$I_N$	2.5
Nominal force [kN]	$F_N$	0.00
Duty cycle		s1

Sensor data	
Pulses	0
Output channels	0

Other data	
Gear ratio	
Gear wheel material	
Suppression components	5 $\mu$ H
Enclosure class	IP 30
Weight [kg]	0.900

Remarks: 3 start worm

### Characteristic curves

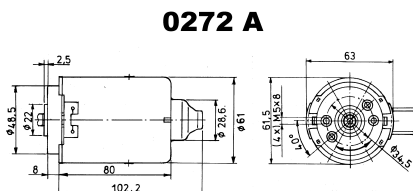

### Motor picture

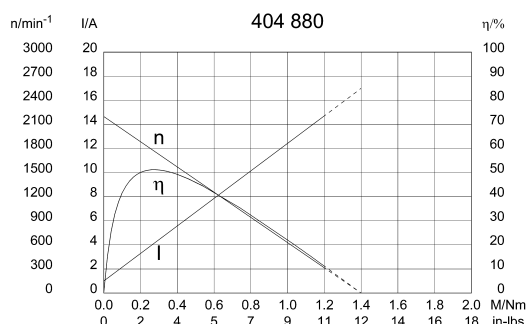
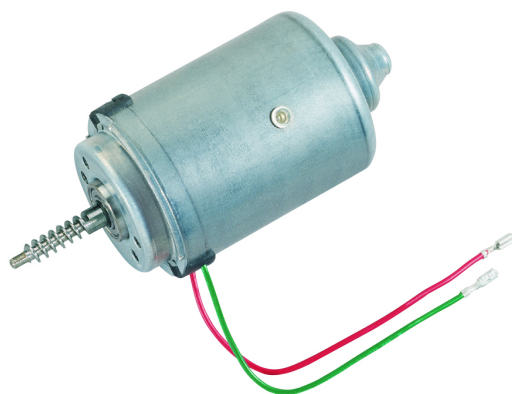

### Output shaft drawing (W), Wiring diagrams (S) and Connector layout (K)

#### W 300

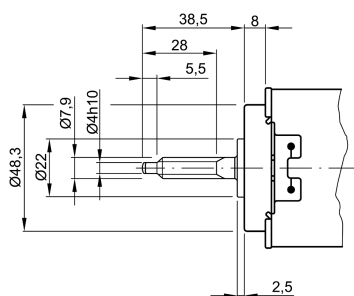

#### S 27

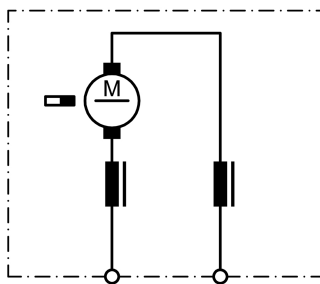

#### K 264

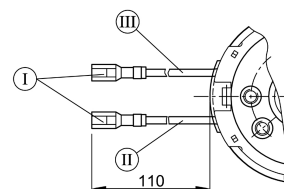

no of starts 3, lead angle 30°33'44", pressure angle 15°, module 1, pitch 3,141 mm (0,124")

I Receptacle for tabs 2,8 x 0,8 DIN 46 247  
 II green  
 III red