

# Series GMPI

## Motor type 405 504

Design Data	
Commutation	Brushed
Direction of rotation	Bi-directional
Bearing type	A:Sleeve - B:Sleeve

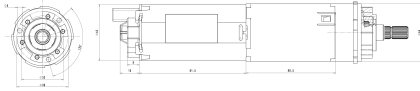

Performance data		
Rated voltage [V]	$U_N$	12
Nominal torque [Nm]	$M_N$	10.0
No-load speed [ $\text{min}^{-1}$ ]	$n_0$	40.0
Nominal power [W]	$P_N$	34.4
Nominal current [A]	$I_N$	8.0
Nominal force [kN]	$F_N$	0.00
Duty cycle		s3

Sensor data	
Pulses	116
Output channels	1

Other data	
Gear ratio	116/1
Gear wheel material	plastic
Suppression components	2,5 $\mu$ H, 47nF, ( )
Enclosure class	IP 30
Weight [kg]	0.800

Remarks:

### Motor picture



### Characteristic curves

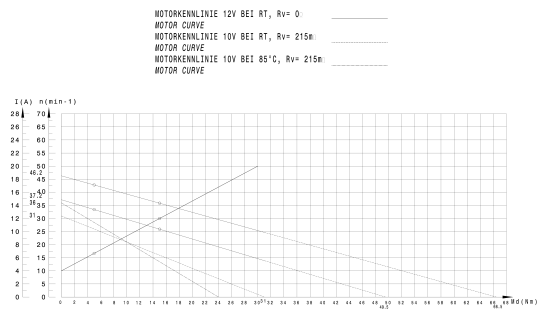

### Output shaft drawing (W), Wiring diagrams (S) and Connector layout (K)

