

DCK31

Als 12 V und 24 V Motor mit Entstörung und Hall-Sensoren



Technische Beschreibung

Motorgehäuse

Magnetfeld

Getriebeart

Getriebegehäuse

Zahnradmaterial

Getriebebeschmierung

Schnittstelle mechanisch

Schnittstelle elektrisch

Sensor

Thermoschutz

Entstörung

Stahlblech tiefgezogen & korrosionsgeschützt

Permanentmagnet

Schneckenradgetriebe

Zinkdruckguss

KST, Metall

Fett, Dauerschmierung

Antriebswelle

Stecker

optional

optional

optional

Anwendungen

Industrie

Garagentor- und Türöffner, Pumpen, Schmiertechnik, Haushaltsgeräte, Linearantriebe

Automobil

Heckklappenverstellung



Abbildung zeigt linke Getriebeausführung

Anschlüsse



Produktmatrix

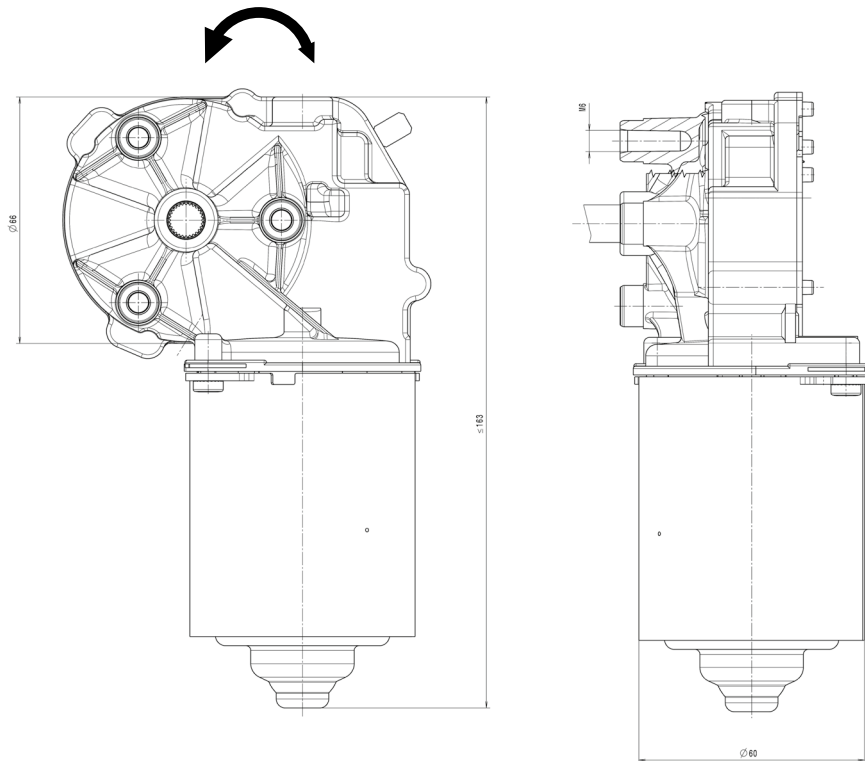
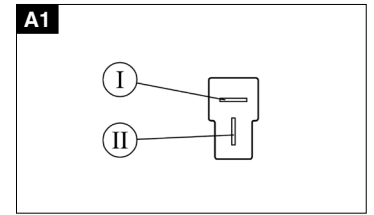
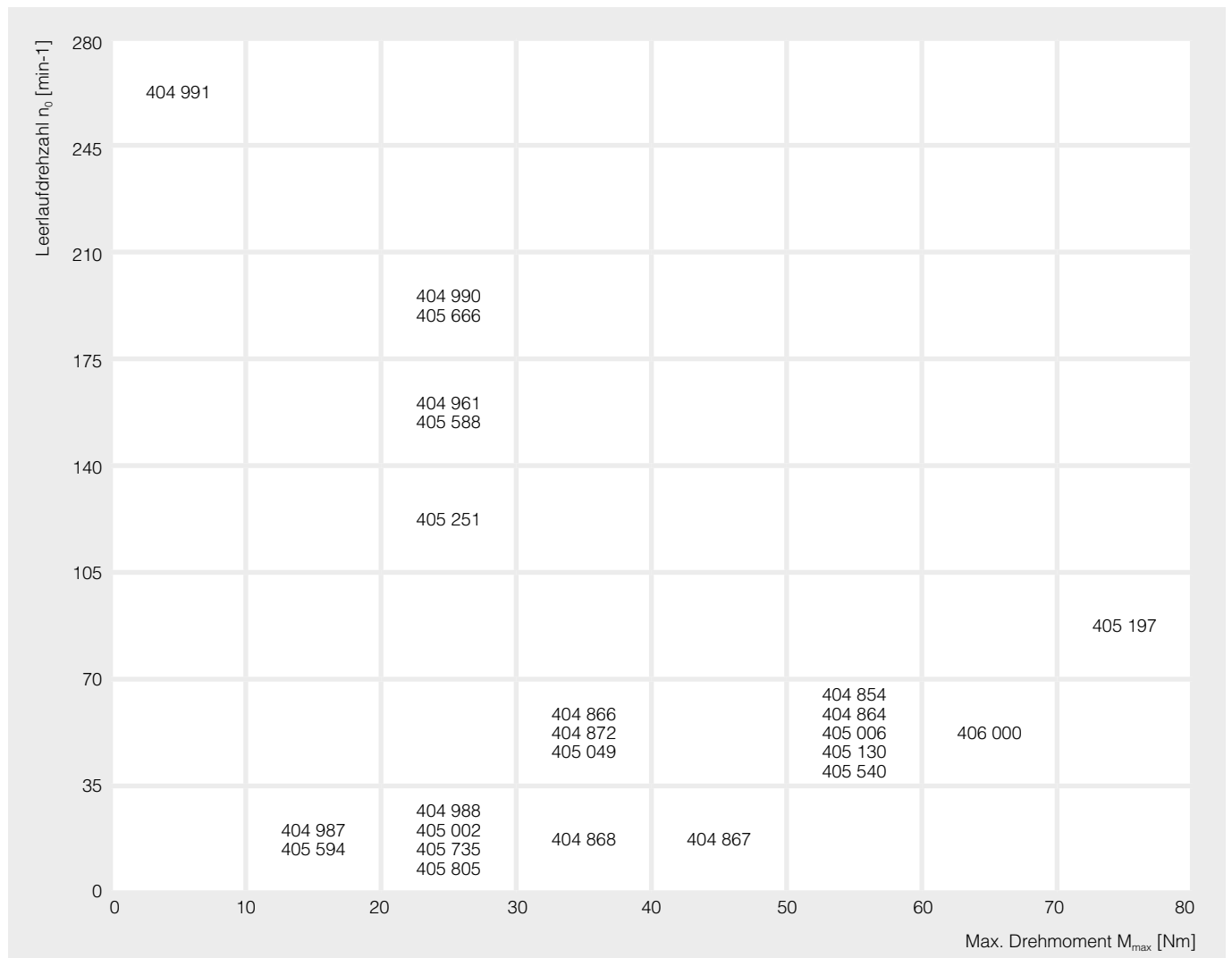

Übersicht

Typ	Nennspannung	Max. Drehmoment	Leerlaufdrehzahl	Nennleistung	Nennstrom	Leerlaufstrom	Max. Strom	Hallsensoren	Untersetzung	Zahnradwerkstoff	Thermoschalter	Entstörung	Getriegehäuse	Kennlinie	Welle	elektr. Anschluss
Typ	V	Nm	min ⁻¹	W	A	A	A	N/1/2	xx:x	D/M	J/N	J/N	lh/rh	K	W	A
404 854	24,0	52,0	63,0	74,0	3,1	2,0	28,1	1	69:1	K	N	J	lh	K7	W1	A1
404 864	24,0	51,1	66,0	75,0	3,1	1,8	30,6	N	69:1	K	N	J	rh	K8	W2	A1
404 866	24,0	33,7	50,0	139,0	7,7	2,5	24,3	N	69:1	K	N	J	rh	K9	W3	A1
404 867	24,0	49,9	35,0	65,0	2,7	2,5	14,8	N	69:1	K	N	J	rh	K10	W4	A1
404 868	24,0	37,0	20,0	32,2	1,3	0,8	9,5	N	69:1	K	N	J	rh	K11	W5	A1
404 872	24,0	34,0	36,0	36,0	1,5	1,4	10,0	N	69:1	K	J	J	lh	K12	W6	A1
404 961	24,0	28,0	160,0	92,0	3,8	3,0	36,3	2	53:2	K	N	J	lh	K4	W7	A1
404 987	24,0	17,0	15,0	31,0	1,3	0,7	4,6	1	78:1	M	N	J	rh	K6	W8	A1
404 988	24,0	28,0	35,0	55,0	2,3	1,5	12,8	1	69:1	K	N	J	rh	K13	W9	A1
404 990	24,0	21,0	195,0	160,0	6,7	3,0	30,0	1	53:2	K	N	J	rh	K18	W10	A1
404 991	24,0	7,4	270,0	120,0	5,0	2,0	16,9	1	41:4	K	N	J	lh	K5	W11	A1
405 002	12,0	28,0	21,0	25,1	2,1	1,5	14,8	N	69:1	K	N	J	rh	K1	W5	A1
405 006	24,0	52,3	63,0	74,0	3,1	2,2	28,0	2	69:1	K	N	J	lh	K7	W12	A1
405 049	12,0	33,5	45,0	79,0	6,6	3,0	31,3	N	69:1	K	N	J	rh	K2	W1	A1
405 130	24,0	54,0	46,0	102,0	4,3	2,5	29,9	1	69:1	K	N	J	lh	K14	W13	A1
405 197	24,0	78,0	88,0	113,0	4,7	3,0	66,0	1	69:1	K	N	J	lh	K15	W1	A1
405 251	24,0	27,6	120,0	137,0	5,7	2,0	27,9	1	53:2	K	N	J	lh	K16	W7	A1
405 540	24,0	51,8	63,5	74,0	3,1	2,2	27,6	1	69:1	K	N	J	lh	K7	W1	A1
405 588	24,0	28,4	160,0	92,0	3,9	3,0	36,4	2	53:2	K	N	J	lh	K4	W10	A1
405 594	24,0	17,0	14,5	31,0	1,3	0,8	5,2	1	78:1	M	N	J	rh	K6	W14	A1
405 666	24,0	21,2	195,0	160,0	6,7	3,0	30,4	2	53:2	K	N	J	rh	K18	W10	A1
405 735	12,0	26,3	21,0	30,0	2,5	1,2	13,8	N	78:1	M	N	J	rh	K3	W8	A1
405 805	24,0	27,8	17,0	36,0	1,5	1,5	5,4	2	69:1	K	N	J	rh	K17	W1	A1
406 000	24,0	64,0	69,0	120,0	5,0	2,4	46,0	1	69:1	K	N	J	lh	K19	W1	A1

Kennlinien

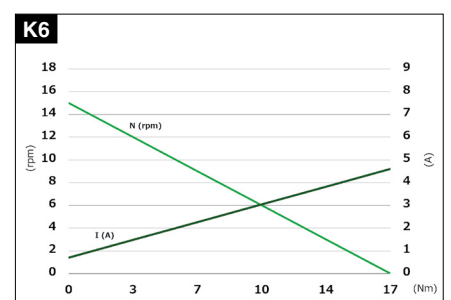
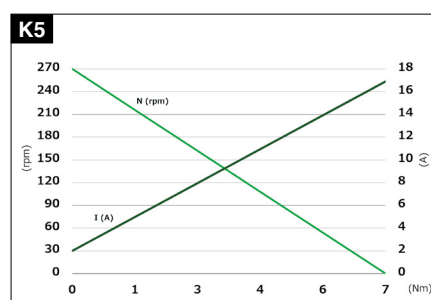
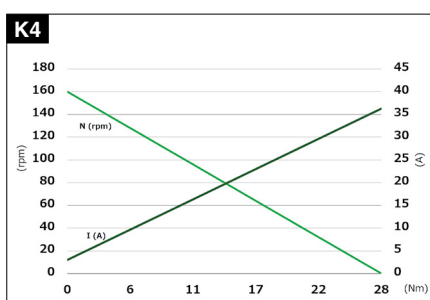
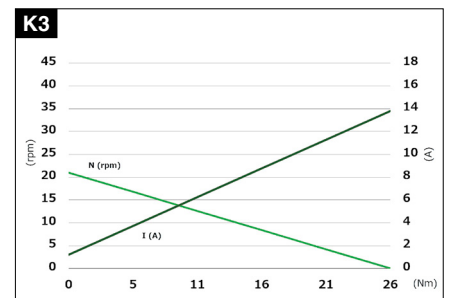
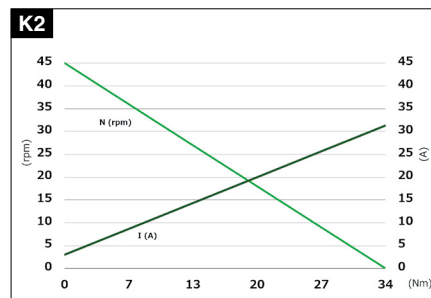
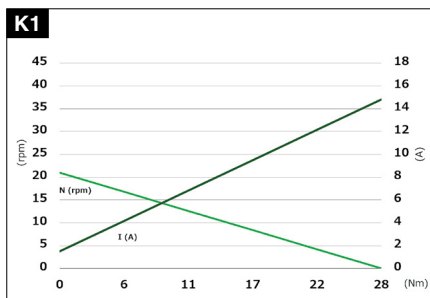

Kennlinien

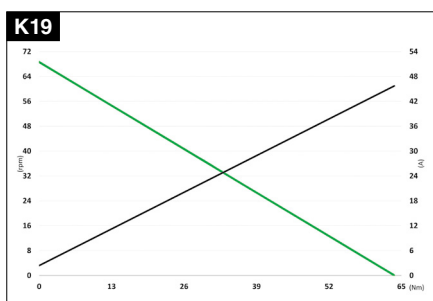
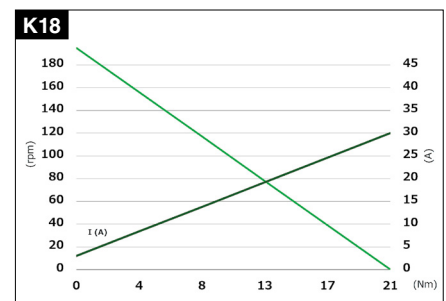
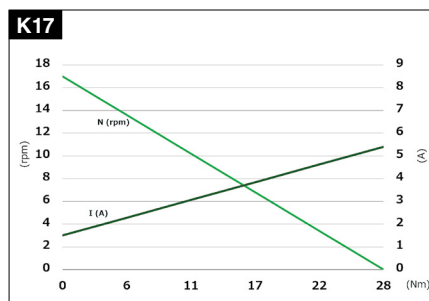
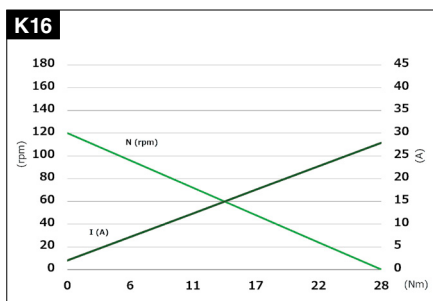
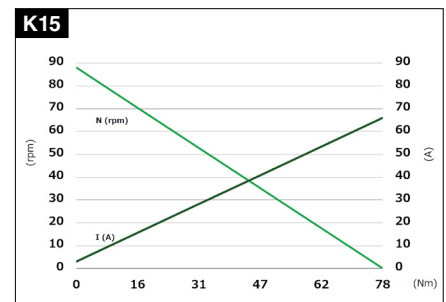
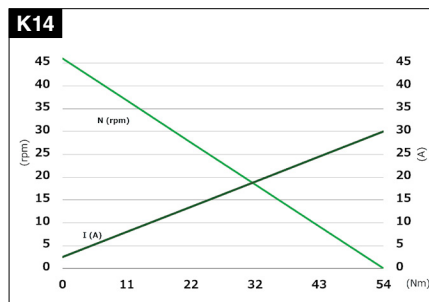
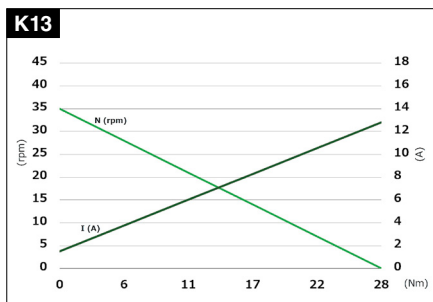
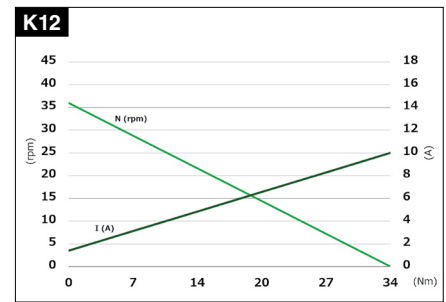
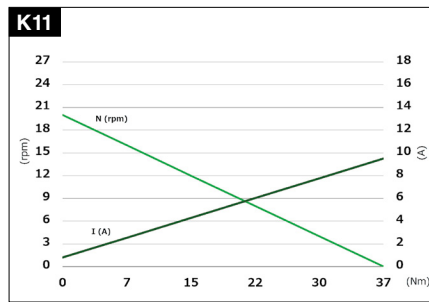
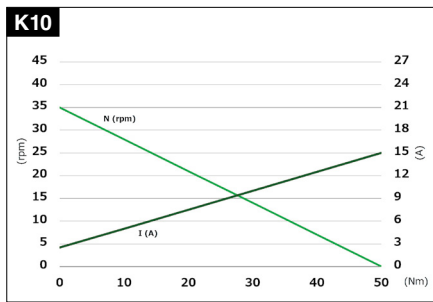
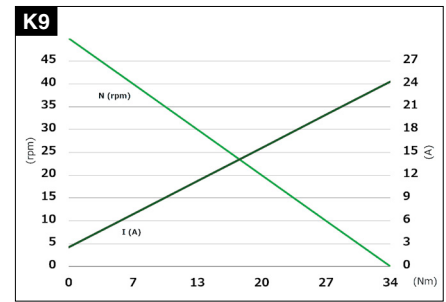
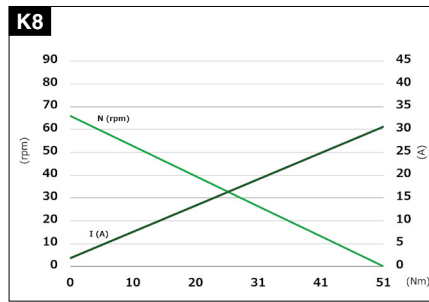
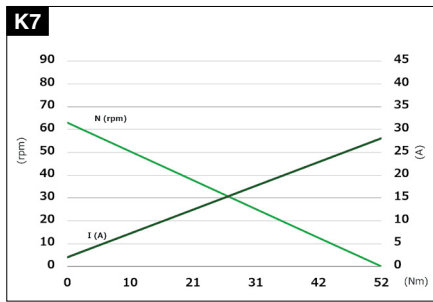

Wellen

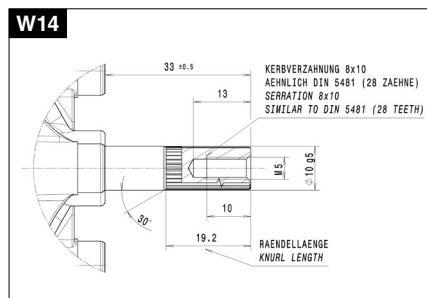
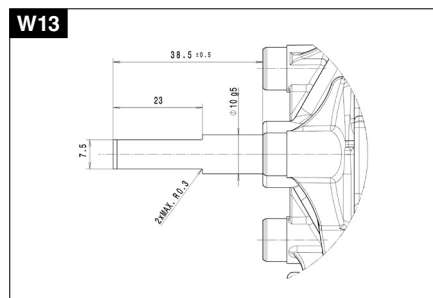
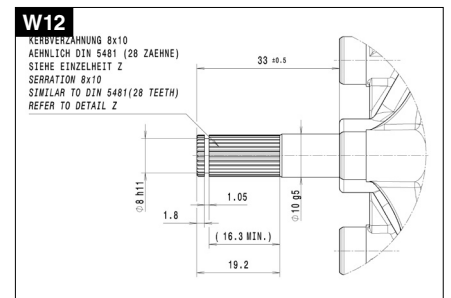
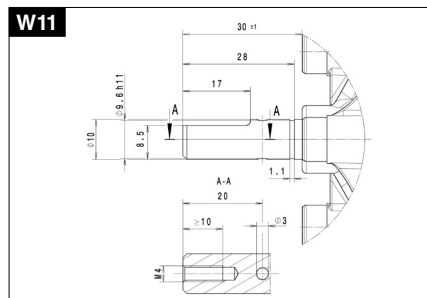
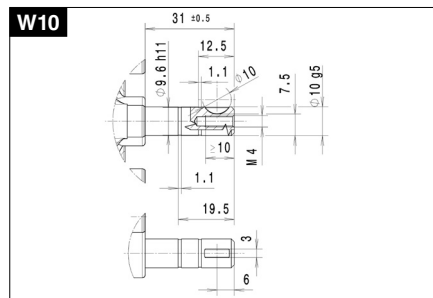
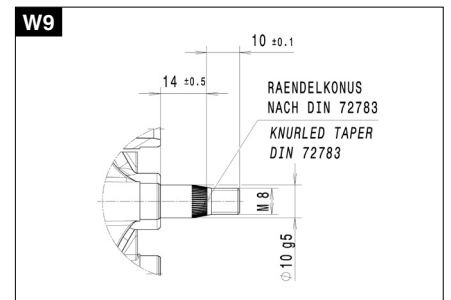
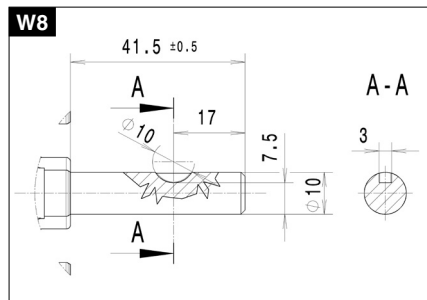
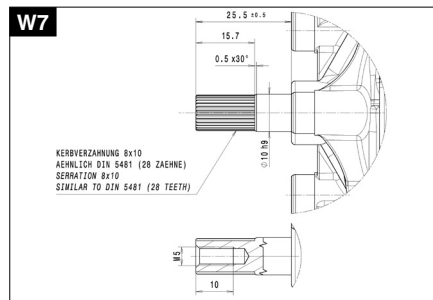
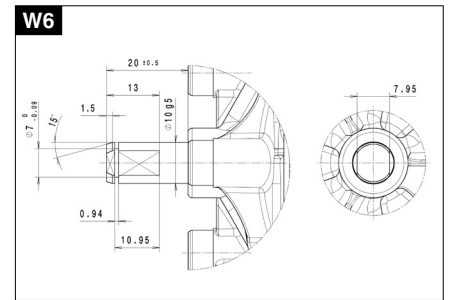
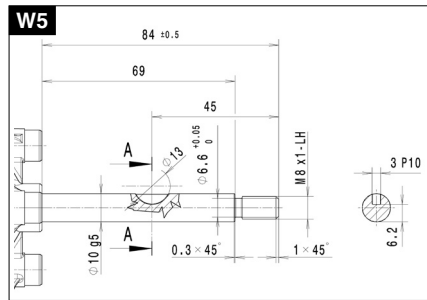
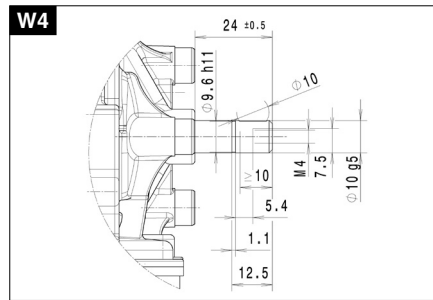
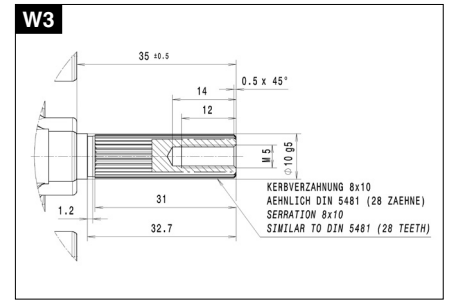
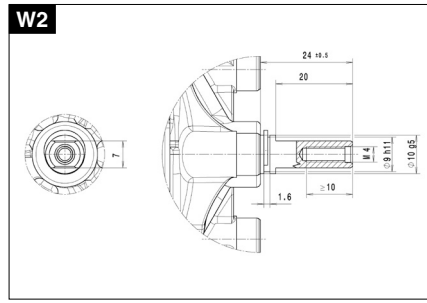
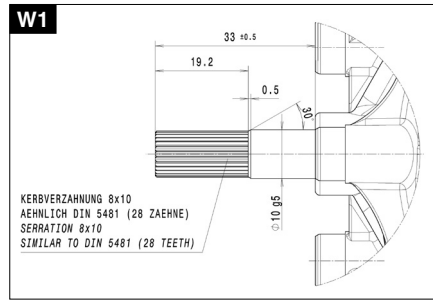

Global distributors

Belgium

Eisses Import B.V.
Admiraal Trompstraat 11
3115 HK Schiedam
Tel. +31 1 02 46 00 18
Fax +31 1 02 46 00 19
info@eissesbv.nl
www.eissesbv.nl

Denmark

Wald Antriebe GmbH
Hanns-Hoerbiger-Straße 1
29664 Walsrode
Tel. +49 51 61 48 63 20
Fax +49 51 61 48 63 233
info@waldantriebe.de
www.waldantriebe.de

Germany - West

101 automation GmbH
Schallbruch 19-21
42781 Haan
Tel. +49 21 29 37 63 50
Fax +49 21 29 37 63 59
sales@101automation.de
www.101automation.de

Germany - East

JBW GmbH
Jakob-Baummann-Straße 5
81249 Munich
Tel. +49 89 89 74 54 30
Fax +49 89 89 74 54 310
info@elektromotore.eu
www.elektromotore.eu

Germany - South

Ott GmbH & Co. KG
Baarstraße 3
78652 Deisslingen
Tel. +49 74 20 93 99 0
info@ott-antriebe.de
www.ott-antriebe.de

Germany - North

Wald Antriebe GmbH
Hanns-Hoerbiger-Straße 1
29664 Walsrode
Tel. +49 51 61 48 63 20
Fax +49 51 61 48 63 233
info@waldantriebe.de
www.waldantriebe.de

Finland

Oy Movetec Ab
Suokalliontie 9
01740 VANTAA
Tel. +35 89 52 59 23 0
Fax +358 9 5259 2333
info@movetec.fi
www.movetec.fi

France

Comotech Industries SAS
6 rue des Blonnières
CS 82441
44115 Haute Goulaine
Tel. +33 2 40 05 05 05
Fax +33 2 40 05 05 03
accueil@comotech.fr
www.comotech-industries.fr

United Kingdom

Electro Mechanical Systems Ltd
Eros House, Calleva Park, Aldermaston
Berkshire RG7 8LN
Tel. +44 11 89 81 73 91
Fax +44 11 89 81 76 13
info@ems-ltd.com
www.ems-limited.co.uk

India

Strategi Automation Solutions Pvt Ltd
Plot 25/B, Dodannakundi Indl Estate
560048 Bangalore
Tel. +91 99 80 56 38 50
Fax +91 80 41 16 30 47
arun@strategiautomation.com
www.strategiautomation.com

Israel

Mechatronics Ltd.
P.O. Box 3818
49130 Petach-Tikva
Tel. +97 2 39 28 88 88
Fax +97 2 39 28 88 80
office@mechatronics.co.il
www.mechatronics.co.il

Italy

Motech S.p.A.
Via Salvemini, 20
41122 Modena
Tel. +39 59 45 42 96
Fax +39 59 45 16 93
m.coda@motech-italia.com
www.motech-italia.com

Japan

Nidec-Shimpo Corp
1 Terada Kohtari, Nagaokakyo City
617-0833 Kyoto
Tel. +81 7 59 58 38 86
Fax +81 7 59 58 36 48
shinichi.takahashi@nidec-shimpo.co.jp
www.nidec-shimpo.co.jp

Canada

Drive Systems Group
7150 Torbram Road, Unit 1 & 2
L4T 3Z8 Mississauga, ON
Tel. +1 90 54 05 03 10
Fax +1 90 54 05 03 13
georger@drivesystemsgroup.com
www.drivesystemsgroup.com

The Netherlands

Eisses Import B.V.
Admiraal Trompstraat 11
3115 HK Schiedam
Tel. +31 1 02 46 00 18
Fax +31 1 02 46 00 19
info@eissesbv.nl
www.eissesbv.nl

Norway

Aratron AS
Bjernerudveien 17
1266 Oslo
Tel. +47 23 19 16 60
Fax +47 23 19 16 61
christer@aratron.no
www.aratron.no

Austria

Kwapil & Co GmbH
Kammelweg 9
1210 Vienna
Tel. +43 12 78 85 85
verkauf@kwapil.com
www.kwapil.com

Poland

WH Technologies Sp. z o o
ul. Pusta 3c
82-550 Prabuty
Tel. +48 58 67 75 571
Fax +48 58 67 75 574
whmotor@wh-tech.pl
www.whmotors.pl

Sweden

KG Knutsson AB
Hammarbacken 8
191 49 Sollentuna
Tel. +46 8 92 30 0
johan.nilsson@kgk.se
www.kgk.se

Switzerland

Antrimon Motion AG
Gotthardstraße 3
5630 Muri (AG)
Tel. +41 5 66 75 40 30
Fax +41 5 66 75 40 31
motion@antrimon.com
www.antrimon.com

Slovakia

Opis Engineering, s.r.o
Lucna 476
03202 Zavazna Poruba
Tel. +42 14 44 55 14 31 0
Fax +42 14 45 54 72 34
opis@opis.sk www.opis.sk

Spain

Útiles Cerámicos, S.A.
C/ San Jaime, 198 - Ap. 118
12550 - Almazora (Castellón)
Tel. +34 96 45 03 333
Fax +34 96 45 50 712
ucersa@ucersa.com
www.ucersa.com

Czech Republic

Opis Engineering k.s.
Selská 64
61400 Brno-Malomerice
Tel. +42 05 43 33 00 55
Gsm +42 07.34.15.08.08
info@opis.cz
www.opis.cz

Turkey

S-MIKRON Elektronik A.S.
Nilufer Ticaret Merkezi 66. Sokak No:6-8
16120 Nilufer-BURSA
Tel. +90 22 44 43 52 33
Fax +90 22 44 43 52 42 ahmetselim@s-
mikron.com.tr www.s-mikron.com.tr

USA

Power Electric
15300 25th Ave North, Suite 400
Plymouth MN 55447
Tel. +1 76 3 383 60 07
Fax +1 76 35 53 12 42 in-
fo@powerelectric.com
www.powerelectric.com



Nidec Motors & Actuators (Germany) GmbH
Seewiesenstraße 9
74321 Bietigheim-Bissingen

Tel. +49 (0) 71 42 / 508-0

sales@nidec-ma.com

www.nidec-ma.com