

Design Data	
Commutation	brushed
Direction of rotation	bidirectional
Bearing Type	A:Ball - B:Ball

Performance data		
Nominal Voltage [V]	U_N	24
Nominal Torque [Nm]	M_N	0,08
Nominal Speed [min^{-1}]	n_N	2.100
Nominal Power [W]	P_N	17,6
Nominal current [A]	I_N	1,0
Nominal force [kN]	F_N	0,00
Duty cycle	none	

Sensor data	
Pulses	0
Output channels	0

Other data	
Gear ratio	
Gear wheel material	
Suppression components	7,5 μ H, 4,7nF
Enclosure class	IP 30
Weight [kg]	0,550

Remarks:

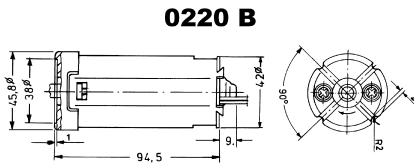

Motor picture

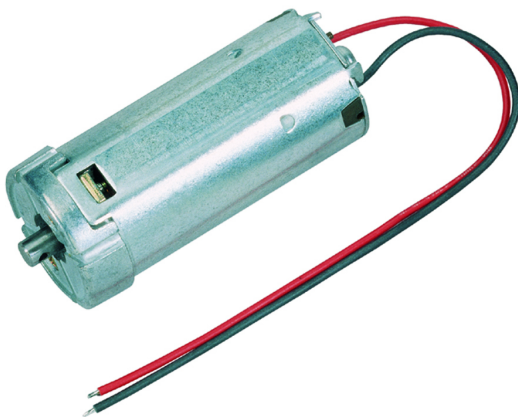

Characteristic Curves

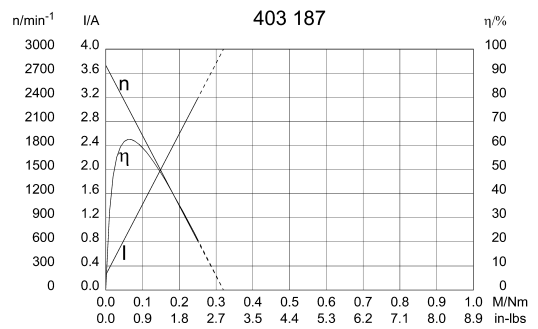

Output shaft drawing (W), Wiring diagrams (S) and Connector layout (K)

